

CHAPTER 7

AMMUNITION

7-1. General

The ammunition (fig. 7-1) for the shotgun is classified as small arms ammunition and is issued in the form of a complete round. The cartridge consists of the lead pellets (00 buckshot), cartridge case (which is water proofed), wadding, propellant powder and primer necessary to fire the weapon. For additional information, refer to SC 1305/30-IL and TM 9-1305-200.

7-2. Functioning Test

Function fire shotgun with once-fired empty rounds (para 5-6).

Note. The empty round should be weighted to approximately the same weight as a "live" round.

7-3. Malfunctions Involving Ammunition and Explosives

Refer to TM 9-1300-206.

Reprinted by special permission of the copyright owner, Olin Mathieson Chemical Corp., Winchester - Western Division, New Haven, Conn.

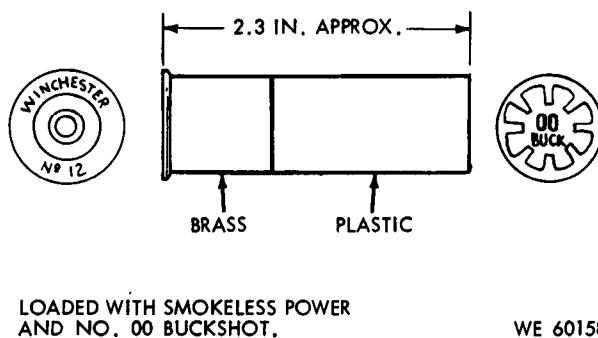

Figure 7-1. 12-gage shotgun cartridge.

CHAPTER 8

FINAL INSPECTION

8-1. Inspection Procedures

Refer to table 8-1.

Table 8-1. Final Inspection

Component or assembly	Point or item of inspection	Method of inspection	Acceptable condition
Shot gun		Visual	Complete and serviceable weapon.
	Exposed surfaces (metal).	Visual	Dull finish (phosphate). Free of scratches and abrasions.
	Exposed surfaces (wood).	Visual	Smooth finish (linseed oil). Free of cracks, chips and gouges.
Trigger pull	Trigger	Functional	3.5 lb minimum to 8.0 lb maximum.
Gun shoulder stock group.		Visual	Must fit mating surfaces of receiver.
	Butt plate	Visual	Must be secured to stock. Mounting holes must not be stripped. Scratches and small gouges are acceptable.
	Swivel assembly	Visual	Must be free swinging and properly secured to stock.
Barrel	Bore and chamber	Visual	Must be free of powder residue, bulges, cracks, and deep pits.
Bayonet band assembly.	Guard and adapter	Visual	Hand guard must be firmly secured to adapter. Locking lug of adapter must be free of burs. Swivel must be free swinging. Front sight must not be loose or protrude through adapter.
Trigger guard group.		Visual	Will not bind or fit loosely in receiver.
	Safety	Functional	Must function properly in "ON" and "OFF" positions without binding and provide a positive stop.
	Trigger guard	Visual	Will not be cracked or damaged which will impair movement of trigger and safety.
	Trigger	Functional	Cock and pull trigger. Any evidence of creep must be removed.
	Carrier assembly	Functional	Must function up and down freely.
	Left and right hand slide arms supports.	Visual	Will not have burs or be bent.
		Functional	Hand function weapon with five empty rounds to insure that shell stop and cartridge cutoff function properly.
Fore end group		Visual	Will not have cracks or other damage. Must function freely with receiver and magazine group and slide arm extension.

Table 8-1. Final Inspection—Continued

Component or assembly	Point or item of inspection	Method of inspection	Acceptable condition
Breech bolt group	Firing pin hole	Visual	Must be secured to slide arm supports.
	Extractor	Visual	Must be free of residue and corrosion.
	Extractor spring	Visual	Free of burs, hand spring tension and the hook will not be cracked or mutilated.
Magazine	Magazine tube	Visual	Press on extractor, with thumb, to see if spring is providing proper tension. Must not be weak.
	Magazine plug, follower.		Must be secured to receiver.
Magazine cap			Must be free of burs, dents, bulges and rust. Follower must slide easily into magazine tube.
Receiver group		Visual	Must be secured to magazine tube.
	Ejector	Functional or visual	Will be free of burs, dents, and bulges on all operating surfaces.
	Ejector support pin	Functional or visual	Will be free of burs and not bent. Should eject empty cartridges.
			Will be free of burs and not broken or bent.

8-2. Functioning and Firing Tests

a. Shotguns will be hand functioned in accordance with paragraph 5-6 and fired on a firing range or a provisional range using five "live" cartridges. Shotguns which fail to meet the functioning and firing tests are to be corrected by the replacement of defective components.

b. Upon completion of firing, shotguns will be properly cleaned and lubricated (para 3-4).

8-3. Completion of Inspection

When shotgun has been restored to a serviceable condition, and inspected to certify serviceability, it will be returned to the user or to stock.

CHAPTER 9

ADMINISTRATIVE STORAGE AND DEMOLITION OF MATERIEL TO PREVENT ENEMY USE

9-1. Administrative Storage

Refer to TM 740-90-1.

9-2. Demolition of Materiel To Prevent Enemy Use

a. Destruction of the shotgun when subject to capture or abandonment in the combat zone, will be undertaken only when, in the judgment of the Commander concerned, such action is necessary. The authority for ordering the destruction of equipment is vested in divisional or higher commanders when the situation requires. If destruction is resorted to, the equipment must be so badly damaged that it cannot be restored to a usable condition in the combat zone either by repair or cannibaliza-

tion. The reporting of the destruction of equipment is to be done through command channels.

b. Priorities for destruction of parts and equipment are:

Receiver and magazine group

Barrel assembly and bayonet band assembly

Breech bolt group

Trigger guard group

c. The same priority for destruction of component parts of a major item necessary to render that item inoperable must be given to the destruction of similar components in spare parts storage areas.

APPENDIX A

REFERENCES

A-1. Publication Indexes

The following indexes should be consulted frequently for the latest changes or revision of references given in this appendix and for new publications relating to material covered in this manual.

Index of Administrative Publications	DA Pam 310-1
Index of Army Films, Transparencies, GTA Charts, and Recordings	DA Pam 108-1
Index of Blank Forms	DA Pam 310-2
Index of Doctrinal, Training, and Organizational Publications	DA Pam 310-3
Index of Graphic Training Aids and Devices	DA Pam 310-5
Index of Supply Catalogs and Supply Manuals (Excluding Types 7, 8 and 9)	DA Pam 310-6
Index of Technical Manuals, Technical Bulletins, Supply Manuals, (Types 7, 8 and 9) Supply Bulletins, and Lubrication Orders	DA Pam 310-4

A-2. Supply Catalogs

Sets, Kits and Outfits Components Lists, Tool Set, Direct and General Support Maintenance, Basic Small Arms	SC 4933-95-CL-E04
Ammunition and Explosives	SC 1305/30-IL

A-3. Forms

The following forms pertain to this material.

- DA Form 2028, Recommended Changes to DA Technical Manual, Parts Lists or Supply Manual 7, 8 and 9
- DA Form 2407, Maintenance Request

A-4. Other Publications

The following explanatory publications pertain to this materiel.

a. Ammunition.

Care, Handling, Preservation and Destruction of Equipment	TM 9-1300-206
Small Arms Ammunition	TM 9-1305-200

b. Cleaning.

Cleaning of Ordnance Materiel	TM 9-208-1
Materials Used for Cleaning, Preserving, Abrading, and Cementing Ordnance Materiel and Related Materials Including Chemicals	TM 9-247

c. Inspection.

Small Arms Weapons: Standards for Visual Inspection of Barrels	TB ORD 437
--	------------

Standards for Oversea Shipment or Domestic Issue of Small Arms,
Aircraft Armament, Towed Howitzers, Mortars, Recoilless Rifles,
Rocket Launchers and Associated Fire Equipment TB 9-1000-247-35

d. Issue of Supplies and Equipment.

The Army Equipment Record Procedures TM 38-750

e. Logistics.

Operation and Maintenance of Army Materiel in Extreme Cold
Weather 0° to -65° TM 9-207

f. Storage.

Administrative Storage of Equipment TM 740-90-1

APPENDIX B

COMBINED ORGANIZATIONAL, DIRECT SUPPORT AND GENERAL SUPPORT REPAIR PARTS AND SPECIAL TOOLS LIST

Section I. INTRODUCTION

B-1. Scope

This appendix lists basic issue items, repair parts and special tools required for the performance of organizational, direct support and general support maintenance of the Winchester Shotgun, Model 1200.

B-2. General

This Basic Issue Items, Repair Parts, and Special Tools List is divided into the following sections:

a. Basic Issue Items—Section II. A list of items which accompany the shotgun and are required by the operator/crew for installation, operation, or maintenance.

b. Maintenance and Operating Supplies—Section III. A listing of maintenance and operating supplies required for initial operation.

c. Prescribed Load Allowance (PLA). Not applicable.

d. Repair Parts—Section IV. A list of repair parts authorized for the performance of maintenance at the organizational level in figure and item number sequence.

e. Special Tools, Test and Support Equipment—Section V. A list of special tools, test and support equipment authorized for the performance of maintenance at the organizational level.

f. Repair Parts—Section VI. A list of repair parts authorized for the performance of maintenance at the direct support and general

support level in figure and item number sequence.

g. Special Tools, Test and Support Equipment—Section VII. A list of special tools, test and support equipment authorized for the performance of maintenance at the direct support and general support level.

h. Federal Stock Number and Reference Number Index—Section VIII. A list of Federal stock numbers in ascending numerical sequence, followed by a list of reference numbers appearing in all the listings, in ascending alphanumeric sequence, crossreferenced to the illustration figure number and item number.

B-3. Explanation of Columns

The following provides an explanation of columns in the tabular lists in sections II through VII.

a. Source, Maintenance, and Recoverability Codes (SMR).

(1) *Source Code.* Indicates the selection status and source for the listed item. Source codes used are:

Code	Explanation
P	Repair parts which are stocked in or supplied from the GSA/DSA, or Army supply system, and authorized for use at indicated maintenance categories.
M	Repair parts which are not procured or stocked but are manufactured at indicated maintenance categories.
A	Assemblies which are not procured or stocked as such but are made up of two or more units, each of which carry individual FSNs and descriptions and are procured and stocked and can be assembled by units at indicated maintenance categories.

Code	Explanation
X	Parts and assemblies which are not procured or stocked; the mortality of which is normally below that of the applicable end item; and the failure of which should result in retirement of the end item from the supply system.
X1	Repair parts which are not procured or stocked, the requirements for which will be supplied by use of next higher assembly or component.
X2	Repair parts which are not stocked. The indicated maintenance category requiring such repair parts will attempt to obtain through cannibalization; if not obtainable through cannibalization, such repair parts will be requisitioned with supporting justification through normal supply channels.
C	Repair parts authorized for local procurement. When not obtainable from local procurement, such repair parts will be requisitioned through normal supply channels with a supporting statement of nonavailability from local procurement.
G	Major assemblies that are procured with PEMA funds for initial issue only to be used as exchange assemblies at DSU and GSU level. These assemblies will not be stocked above DSU and GSU level or returned to Depot supply level.

(2) *Maintenance Code.* Indicates the lowest category of maintenance authorized to install the item. The maintenance level codes are:

Code	Explanation
C	Crew/Operator
O	Organizational Maintenance
F	Direct Support Maintenance
H	General Support Maintenance

(3) *Recoverability Code.* Indicates whether unserviceable items should be returned for recovery or salvage.

Code	Explanation
R	Repair parts and assemblies which are economically repairable at DSU and GSU activities and are normally furnished by supply on an exchange basis.
T	High dollar value recoverable repair parts which are subject to special handling and are issued on an exchange basis. Such repair parts are normally repaired or overhauled at depot maintenance activities.
U	Repair parts specifically selected for salvage by reclamation units because of precious metal content, critical materials, high dollar value reusable casings, etc.
S	Repair parts and assemblies which are economically repairable at DSU and GSU activities and normally are furnished by supply on an exchange basis. However, when these items are determined to be uneconomically repairable by a GSU they will be evacuated to a depot for evaluation and analysis before final disposition.

No Code Indicated Parts will be considered expendable.

b. *Federal Stock Number.* Indicates the Federal stock number assigned to the item and will be used for requisitioning purposes.

c. *Description.* Indicates the Federal item and a brief description of the item. The abbreviation "w/e" when used as a part of the nomenclature, indicates the Federal stock number includes all armament, equipment, accessories, and repair parts issued with the item. A part number or other reference number is followed by the applicable five-digit Federal supply code for manufacturers in parentheses. Repair parts quantities included in the kits, sets, and assemblies are shown in front of the repair part name.

d. *Unit of Measure (U/M).* A 2 character alphabetic abbreviation indicating the amount or quantity of the item upon which the allowances are based, e.g., ft, ea, pr, etc.

e. *Quantity Incorporated in Unit.* Indicates the quantity of the item used in the functional group or assembly. A "V" appearing in this column in lieu of a quantity indicates that a definite quantity cannot be indicated (e.g. shims, spacers, etc).

f. *Quantity Furnished with Equipment.* Indicates the quantity of an item furnished with the equipment (BIIL only).

g. *Component Application.* Identifies the component application of each maintenance or operating supply item (M&O supplies only).

h. *Quantity Required for Initial Operation.* Indicates the quantity of each maintenance or operating supply item required for initial operation of the equipment (M&O supplies only).

i. *Quantity Required for 8 Hours Operation.* Indicates the estimated quantities required for an average 8 hours of operation (M&O supplies only).

j. *Notes.* Indicates informative notes keyed to data appearing in a preceding column (M&O supplies only).

k. *15-Day Organizational Maintenance Allowances.*

(1) The allowance columns are divided into four subcolumns. Indicated in each sub-column opposite the first appearance of each

item is the total quantity of items authorized for the number of equipments supported. Subsequent appearances of the same item will have the letters "RE" in the allowance columns. Items authorized for use as required but not for initial stockage are identified with an asterisk in the allowance column.

(2) The quantitative allowances for organizational level of maintenance represents one initial prescribed load for a 15-day period for the number of equipments supported. Units and organizations authorized additional prescribed loads will multiply the number of prescribed loads authorized by the quantity of repair parts reflected in the appropriate density column to obtain the total quantity of repair parts authorized.

(3) Organizational units providing maintenance for more than 100 of these equipments shall determine the total quantity of parts required by converting the equipment quantity to a decimal factor by placing a decimal point before the next to last digit of the number to indicate hundredths, and multiplying the decimal factor by the parts quantity authorized in the 51-100 allowance column. Example, authorized allowance for 51-100 equipments is 12; for 140 equipments multiply 12 by 1.40 or 16.80 rounded off to 17 parts required.

(4) Subsequent changes to allowances will be limited as follows: No change in the range of items is authorized. If additional items are considered necessary, recommendation should be forwarded to Commanding General, Headquarters, U.S. Army Weapons Command, ATTN: AMSWE-SMM-SA, Rock Island, Illinois 61201 for exception or revision to the allowance list. Revision to the range of item authorized will be made by Headquarters, U.S. Army Weapons Command based upon engineering experience and demand data, or TAERS information.

l. 30-Day DS/GS Maintenance Allowances.

Note. Allowances in GS column are for GS maintenance only.

(1) The allowance columns are divided into three subcolumns. Indicated in each subcolumn, opposite the first appearance of each item, is the total quantity of items authorized for the number of equipments supported. Sub-

sequent appearances of the same item will have the letters "RE" in the applicable allowance columns. Items authorized for use as required but not for initial stockage are identified with an asterisk in the allowance column.

(2) The quantitative allowances for DS/GS levels of maintenance will represent initial stockage for a 30-day period for the number of equipments supported.

(3) Determination of the total quantity of parts required for maintenance of more than 100 of these equipments can be accomplished by converting the equipment quantity to a decimal factor by placing a decimal point before the next to last digit of the number to indicate hundredths, and multiplying the decimal factor by the parts quantity authorized in the 51-100 allowance column. Example, authorized allowance for 51-100 equipments is 40; for 150 equipments multiply 40 by 1.50 or 60 parts required.

m. 1-Year Allowances Per 100 Equipments/Contingency Planning Purposes. Indicates opposite the first appearance of each item the total quantity required for distribution and contingency planning purposes. The range of items indicates total quantities of all authorized items required to provide for adequate support of 100 equipments for one year.

n. Illustration.

(1) *Figure Number.* Indicates the figure number of the illustration in which the item is shown.

(2) *Item Number.* Indicates the callout number used to reference the item in the illustration.

B-4. How to Locate Repair Parts

a. When Federal stock number or reference number is unknown:

(2) *First.* Using the table of contents determine the functional group or subgroup, i.e., stock group, barrel and bayonet band assembly, breech bolt group within which the repair part belongs. This is necessary because separate illustrations are prepared for functional groups or subgroups and listings are divided into the same groups.

(2) *Second.* Find the illustration cover.

ing the functional group or subgroup to which the repair part belongs.

Note. Do not bypass this part of the procedure. Positive identification of the repair part is required.

(3) *Third.* Identify the repair part on the illustration and note the illustration figure and item number of the repair part.

(4) *Fourth.* Using the Repair Parts Listing, find the functional group or subgroup to which the repair part belongs and locate the illustration figure and item number noted on the illustration.

b. When Federal stock number or reference number is known:

(1) *First.* Using the Index of Federal Stock Numbers and Reference Numbers, find the pertinent Federal stock number or reference number. This index is in ascending FSN followed by a list of reference numbers in

alpha-numeric sequence, cross-referenced to the illustration figure number and item number.

(2) *Second.* Using the Repair Part Listing, find the functional group or subgroup of the repair part and the illustration figure number and item number referenced in the Index of Federal Stock Numbers and Reference Numbers.

B-5. Federal Supply Codes for Manufacturers

Code	Manufacturers
19204	Rock Island Arsenal Rock Island, Ill. 61201
19205	Springfield Armory Springfield, Mass. 01101
66118	Olin Mathieson Chemical Corp Winchester-Western Division 275 Winchester Ave New Haven, Conn. 06504

Section II. BASIC ISSUE ITEMS LIST

(1) Source, Maint. and Recov. code			(2) Federal stock No.	(3) Description	(4) Unit of Meas	(5) Qty. Inc. In Unit	(6) Qty. Furn. With Equip.	(7) Illustration	
(a) Source	(b) Maint.	(c) Recov.						(a) Fig. no.	(b) Item No.
P	C		1005-913-2602	REPAIR PARTS: NONE AUTHORIZED TOOLS AND EQUIPMENT BAYONET: M1917 11686400 (19204) ROD, CLEANING, SMALL ARMS: M9 6301446 (19204)	EA EA		1 1	B-1 B-1	3 1
P	C		1005-630-1446	SCABBARD, BAYONET: M1917 7265706 (19205)	EA		1	B-1	2
P	C		1095-726-5706						
P	C		1005-654-4058	SLING, SMALL ARMS: M1, WEBBING 6544058 (19204)	EA		1	B-1	4

Section III. MAINTENANCE AND OPERATING SUPPLIES

(1) Component Application	(2) Federal stock No.	(3) Description	(4) Qty. Required For Initial Operation	(5) Qty. Required For 8 Hours Operation	(6) Notes
SHOTGUN	1005-288-3565	SWAB, SMALL ARMS CLEANING: COTTON 2½ SQ (1000 IN PKG) 5019316 (19205)	*		FOR GENERAL CLEANING AND LUBRICATING PURPOSES (ITEM IS AUTHORIZED FOR USE AS INDICATED BY THE ASTERISK)

Section IV. REPAIR PARTS FOR ORGANIZATIONAL MAINTENANCE

(1) Source, Maint. and Recov. code			(2) Federal stock No.	(3) Description	(4) Unit of Meas	(5) Qty. Inc. In Unit	(6) 15 Day Organizational Maint. Allowance				(7) Illustration	
(a) Source	(b) Maint.	(c) Recov.					(A) 1-5	(B) 6-20	(C) 21-50	(D) 51-100	(A) Figure no.	(B) Item no.
P	O		5305-930-5729	REPAIR PARTS FOR: SCREW, BAYONET BAND: 6284554 (19205)	EA	3	*	*	*	*	B-2	11
P	O		1005-939-7170	BAND ASSEMBLY, BAYONET: 11686389 (19205)	EA	1	*	*	*	*	B-2	12

Section V. SPECIAL TOOLS, TEST AND SUPPORT EQUIPMENT FOR ORGANIZATIONAL MAINTENANCE

(1) Source, Maint. and Recov. code			(2) Federal Stock No.	(3) Description	(4) Unit of Meas	(5) Qty. Inc. In Unit	(6) 15 Day Organizational Maint. Allowance				(7) Illustration	
(a) Source	(b) Maint.	(c) Recov.					(A) 1-5	(B) 6-20	(C) 21-50	(D) 51-100	(a) Fig. no.	(b) Item No.
P	O		1005-288-3565	TOOLS AND EQUIPMENT AUTHORIZED FOR UNIT REPLACEMENT SWAB, SMALL ARMS CLEANING: COTTON, 2½ SQ (1000 IN PKG) 5019316 (19204)	PG		*	*	*	2		
P	C		1005-630-1446	ROD, CLEANING, SMALL ARMS: M9 6301446 (19204)	EA		*	*	*	2	B-1	1
P	C		1005-654-4058	SLING, SMALL ARMS: M1, WEBBING 6544058 (19204)	EA		*	*	*	2	B-1	4
P	C		1005-913-2602	BAYONET: M1917 11686400 (19204)	EA		*	*	*	2	B-1	3
P	C		1095-726-5706	SCABBARD, BAYONET: M1917 7265706 (19205)	EA		*	*	*	2	B-1	2

Section VI. REPAIR PARTS FOR DIRECT AND GENERAL SUPPORT MAINTENANCE

(1) Source, Maint. and Recov. code			(2) Federal stock No.	(3) Description	(4) Unit of Meas	(5) Qty. Inc. In Unit	(6) Direct Support 30-Day Maint. Allowance			(7) General Support 30-Day Maint. Allowance			(8) 1 Yr. Alw. Per 100 Equip/ Cntgcy Plan- ning	(9) Illustration		
(a) Source	(b) Maint.	(c) Recov.					(A) 1-20	(B) 21-50	(C) 51-100	(A) 1-20	(B) 21-50	(C) 51-100		(a) Fig. no.	(b) Item No.	
				REPAIR PARTS FOR: MAJOR GROUPS, ASSEMBLIES AND ATTACHING PARTS												
A				GUN SHOULDER STOCK GROUP			1							B-2	1	
P	F		5305-021-0143	SCREW, BUTT PLATE: PHILLIPS HD 12009112 (66118)		EA	2	*	*	2	*	*	2	24	B-2	2
P	F		1005-809-0721	PLATE, BUTT, SHOULDER: 8812-G-1390 (66118)		EA	1	*	*	2	*	*	2	24	B-2	3
P	F		5306-020-9913	BOLT, MACHINE: 120014102 (66118)		EA	1	*	*	2	*	*	2	24	B-2	4
P	F		5310-017-8687	WASHER, LOCK: 120015102 (66118)		EA	1	*	*	2	*	*	2	24	B-2	5
P	F		1005-614-6873	SCREW, BUTT PLATE, SMALL: SLTD 6146873 (19205)		EA	2	*	*	2	*	*	2	24	B-2	6
P	F		1005-614-7721	SWIVEL ASSEMBLY, SLING: 6147721 (19205)		EA	1	*	*	2	*	*	1	24	B-2	7
P	F		1005-805-3367	STOCK, GUN, SHOULDER: 120013102-D (66118)		EA	1	*	*	2	*	*	2	24	B-2	8
P	F		1005-805-3754	CAP, MAGAZINE: 120034102 (66118)		EA	1	*	*	2	*	*	2	24	B-2	9
A				BARREL AND BAYONET BAND ASSEMBLY			1							B-2	10	
P	O		5305-930-5729	SCREW, BAYONET BAND: 6284554 (19205)		EA	3	*	*	2	*	*	2	24	B-2	11
P	O		1005-939-7170	BAND ASSEMBLY, BAYONET: 11686389 (19205)		EA	1	*	*	2	*	*	2	24	B-2	12
P	F		1005-805-3267	SIGHT, FRONT: 11686387 (19204)		EA	1	*	*	2	*	*	2	24	B-2	13
P	F		1005-805-4048	BARREL ASSEMBLY: 120041028 (66118)		EA	1	*	*	2	*	*	2	24	B-2	14
P	F		5315-017-8673	PIN, TRIGGER GUARD: 120066102 (66118)		EA	1	*	*	2	*	*	2	24	B-2	15
A				TRIGGER GUARD GROUP			1							B-2	16	
P	F		5305-021-0114	SCREW, RETAINING: SLIDE ARM BRIDGE 12002514 (66118)		EA	1	*	*	2	*	*	2	24	B-2	17
A				FORE END GROUP			1							B-2	18	
P	F		1005-805-4246	CAP, SLIDE ARM EXTENSION: 120054102 (66118)		EA	1	*	*	2	*	*	2	24	B-2	19

(1) Source, Maint. and Recov. code			(2) Federal stock No.	(3) Description	(4) Unit of Meas	(5) Qty. Inc. In Unit	(6) Direct Support 30-Day Maint. Allowance			(7) General Support 30-Day Maint. Allowance			(8) 1 Yr. Alw. Per 100 Equip/ Cntgty Plan- ning	(9) Illustration	
(a) Source	(b) Maint.	(c) Recov.					(A) 1-20	(B) 21-50	(C) 51-100	(A) 1-20	(B) 21-50	(C) 51-100		(a) Fig. no.	(b) Item No.
P.	F		1005-805-3709	FORE END, GUN: 120029102-AC (66118)	EA	1	*	*	2	*	*	2	24	B-2	20
P	F		1005-805-4257	EXTENSION, SLIDE ARM: 120055102-NS (66118)	EA	1	*	*	2	*	*	2	24	B-2	21
A				BREECH BOLT GROUP		1								B-2	22
A				RECEIVER AND MAGAZINE GROUP		1								B-2	23
P	F		1005-805-3537	EJECTOR, CARTRIDGE: 120022102 (66118)	EA	1	*	*	2	*	*	2	24	B-2	24
P	F		1005-805-4195	PLUG, MAGAZINE TUBE: 120044102 (66118)	EA	1	*	*	2	*	*	2	24	B-2	25
P	F		1005-805-3409	SPRING, HELICAL COMPRESSION: MAGAZINE 120016212 (66118)	EA	1	*	*	2	*	*	2	24	B-2	26
P	F		1005-805-3939	FOLLOWER, MAGAZINE: 120037102 (66118)	EA	1	*	*	2	*	*	2	24	B-2	27
X				RECEIVER AND MAGAZINE TUBE: TRIGGER GUARD GROUP										B-2	28
P	F		5305-021-0411	SCREW, TRIGGER STOP PIN: 120062102 (66118)	EA	1	*	*	2	*	*	2	24	B-3	1
P	F		1005-805-4259	SUPPORT, LEFT HAND SLIDE ARM: 120057102 (66118)	EA	1	*	*	2	*	*	2	24	B-3	2
P	F		1005-805-4284	SUPPORT, RIGHT HAND SLIDE ARM: 120059102 (66118)	EA	1	*	*	2	*	*	2	24	B-3	3
P	F		1005-805-3425	CARRIER ASSEMBLY: 120017102 (66118)	EA	1	*	*	2	*	*	2	24	B-3	4
P	F		1005-805-3440	PLUNGER, CARRIER PAWL: 120018102 (66118)	EA	1	*	*	2	*	*	2	24	B-3	5
P	F		1005-805-3475	SPRING, HELICAL COMPRESSION: (CARRIER PLUNGER) 120019102 (66118)	EA	1	*	*	2	*	*	2	24	B-3	6
P	F		1005-805-3488	DISCONNECTOR, ASSEMBLY: 120020102 (66118)	EA	1	*	*	2	*	*	2	24	B-3	7
P	F		1005-805-3489	SPRING, HELICAL TORSION: (DISCONNEC- TOR) 120021102 (66118)	EA	1	*	*	2	*	*	2	24	B-3	8
P	F		1005-805-4218	BRACKET ASSEMBLY, SEAR: 120050102 (66118)	EA	1	*	*	2	*	*	2	24	B-3	9
P	F		1005-805-3744	PIN, HAMMER: 120032102 (66118)	EA	1	*	*	2	*	*	2	24	B-3	10

P	F	1005-805-4066	SUPPORT, HAMMER SPRING: 120041270 (66118)	EA	1	*	*	2	*	*	2	24	B-3	11
P	F	1005-805-3745	SPRING, HELICAL TORSION (HAMMER) 120033102 (66118)	EA	1	*	*	2	*	*	2	24	B-3	12
P	F	1005-805-3710	HAMMER, FIRING, SMALL ARMS: 120030102 (66118)	EA	1	*	*	2	*	*	2	24	B-3	13
P	F	1005-805-4201	SAFETY, SMALL ARMS: 120049102-NS (66118)	EA	1	*	*	2	*	*	2	24	B-3	14
P	F	5315-17-8672	PIN, TRIGGER: 120067102 (66118)	EA	1	*	*	2	*	*	2	24	B-3	15
P	F	1005-805-4290	TRIGGER: 120061102 (66118)	EA	1	*	*	2	*	*	2	24	B-3	16
P	F	1005-805-3711	HOUSING, HAMMER: 120031102-NS (66118)	EA	1	*	*	2	*	*	2	24	B-3	17
P	F	1005-805-4291	GUARD, TRIGGER: 120063102-NS (66118)	EA	1	*	*	2	*	*	2	24	B-3	18
BREECH BOLT GROUP														
P	F	1005-805-4244	BRIDGE, SLIDE ARM: 120053102 (66118)	EA	1	*	*	2	*	*	2	24	B-4	1
P	F	1005-805-3632	PIN, FIRING: 120026102 (66118)	EA	1	*	*	2	*	*	2	24	B-4	2
P	F	1005-805-3702	SPRING, HELICAL, COMPRESSION: (FIRING PIN) 120028102 (66118)	EA	1	*	*	2	*	*	2	24	B-4	3
P	F	1005-805-3382	PIN, CAM: 120016102 (66118)	EA	1	*	*	2	*	*	2	24	B-4	4
P	F	1005-805-3686	COLLAR, FIRING PIN: 120027102 (66118)	EA	1	*	*	2	*	*	2	24	B-4	5
P	F	1005-805-3602	SPRING, HELICAL, COMPRESSION: (EXTRACTOR) 120025102 (66118)	EA	1	*	*	2	*	*	2	24	B-4	6
P	F	1005-805-3555	EXTRACTOR, CARTRIDGE: 120024102 (66118)	EA	1	*	*	24	*	*	2	24	B-4	7
P	F	1005-805-4306	BOLT, BREECH: 12008102 (66118)	EA	1	*	*	2	*	*	2	24	B-4	8
P	F	1005-805-3366	SLIDE, BREECH BOLT: 120012102-A (66118)	EA	1	*	*	2	*	*	2	24	B-4	9

Section VII. SPECIAL TOOLS, TEST AND SUPPORT EQUIPMENT LIST

(1) Source, Maint. and Recov. code			(2) Federal stock No.	(3) Description	(4) Unit of Meas	(5) Qty. Inc. In Unit	(6) Direct Support 30-Day Maint. Allowance			(7) General Support 30-Day Maint. Allowance			(8) 1 Yr. Alw. Per 100 Equip/ Cntgcy Plan- ning	(9) Illustration	
(a) Source	(b) Maint.	(c) Recov.					(A) 1-20	(B) 21-50	(C) 51-100	(A) 1-20	(B) 21-50	(C) 51-100		(a) Fig. no.	(b) Item No.
P	O		1005-288-3565	SWAB, SMALL ARMS, CLEANING: COTTON, 2½ SQ (1000 IN PKG) 5019316 (19204)	PG	--	*	*	2	*	*	2	24	-	-
P	C		1005-630-1446	ROD, CLEANING: M9 6301446 (19204)	EA	--	*	*	2	*	*	2	24	B-1	1
P	C		1005-654-4058	SLING, SMALL ARMS: M1, WEBBING 6544058 (19204)	EA	--	*	*	2	*	*	2	24	B-1	4
P	C		1005-913-2602	BAYONET: M1917 11686400 (19204)	EA	--	*	*	2	*	*	2	24	B-1	3
P	C		1095-726-5706	SCABBARD, BAYONET: M1917 7265706 (19205)	EA	--	*	*	2	*	*	2	24	B-1	2

P	F	1005-805-4066	SUPPORT, HAMMER SPRING: 120041270 (66118)	EA	1	*	*	2	*	*	2	24	B-3	11
P	F	1005-805-3745	SPRING, HELICAL TORSION (HAMMER) 120033102 (66118)	EA	1	*	*	2	*	*	2	24	B-3	12
P	F	1005-805-3710	HAMMER, FIRING, SMALL ARMS: 120030102 (66118)	EA	1	*	*	2	*	*	2	24	B-3	13
P	F	1005-805-4201	SAFETY, SMALL ARMS: 120049102-NS (66118)	EA	1	*	*	2	*	*	2	24	B-3	14
P	F	5315-17-8672	PIN, TRIGGER: 120067102 (66118)	EA	1	*	*	2	*	*	2	24	B-3	15
P	F	1005-805-4290	TRIGGER: 120061102 (66118)	EA	1	*	*	2	*	*	2	24	B-3	16
P	F	1005-805-3711	HOUSING, HAMMER: 120031102-NS (66118)	EA	1	*	*	2	*	*	2	24	B-3	17
P	F	1005-805-4291	GUARD, TRIGGER: 120063102-NS (66118)	EA	1	*	*	2	*	*	2	24	B-3	18
BREECH BOLT GROUP														
P	F	1005-805-4244	BRIDGE, SLIDE ARM: 120053102 (66118)	EA	1	*	*	2	*	*	2	24	B-4	1
P	F	1005-805-3632	PIN, FIRING: 120026102 (66118)	EA	1	*	*	2	*	*	2	24	B-4	2
P	F	1005-805-3702	SPRING, HELICAL, COMPRESSION: (FIRING PIN) 120028102 (66118)	EA	1	*	*	2	*	*	2	24	B-4	3
P	F	1005-805-3382	PIN, CAM: 120016102 (66118)	EA	1	*	*	2	*	*	2	24	B-4	4
P	F	1005-805-3686	COLLAR, FIRING PIN: 120027102 (66118)	EA	1	*	*	2	*	*	2	24	B-4	5
P	F	1005-805-3602	SPRING, HELICAL, COMPRESSION: (EXTRACTOR) 120025102 (66118)	EA	1	*	*	2	*	*	2	24	B-4	6
P	F	1005-805-3555	EXTRACTOR, CARTRIDGE: 120024102 (66118)	EA	1	*	*	24	*	*	2	24	B-4	7
P	F	1005-805-4306	BOLT, BREECH: 12008102 (66118)	EA	1	*	*	2	*	*	2	24	B-4	8
P	F	1005-805-3366	SLIDE, BREECH BOLT: 120012102-A (66118)	EA	1	*	*	2	*	*	2	24	B-4	9

Section VII. SPECIAL TOOLS, TEST AND SUPPORT EQUIPMENT LIST

(1) Source, Maint. and Recov. code			(2) Federal stock No.	(3) Description	(4) Unit of Meas	(5) Qty. Inc. In Unit	(6) Direct Support 30-Day Maint. Allowance			(7) General Support 30-Day Maint. Allowance			(8) 1 Yr. Alw. Per 100 Equip/ Cntgcy Plan- ning	(9) Illustration	
(a) Source	(b) Maint.	(c) Recov.					(A) 1-20	(B) 21-50	(C) 51-100	(A) 1-20	(B) 21-50	(C) 51-100		(a) Fig. no.	(b) Item No.
P	O		1005-288-3565	SWAB, SMALL ARMS, CLEANING: COTTON, 2½ SQ (1000 IN PKG) 5019316 (19204)	PG	--	*	*	2	*	*	2	24	-	-
P	C		1005-630-1446	ROD, CLEANING: M9 6301446 (19204)	EA	--	*	*	2	*	*	2	24	B-1	1
P	C		1005-654-4058	SLING, SMALL ARMS: M1, WEBBING 6544058 (19204)	EA	--	*	*	2	*	*	2	24	B-1	4
P	C		1005-913-2602	BAYONET: M1917 11686400 (19204)	EA	--	*	*	2	*	*	2	24	B-1	3
P	C		1095-726-5706	SCABBARD, BAYONET: M1917 7265706 (19205)	EA	--	*	*	2	*	*	2	24	B-1	2

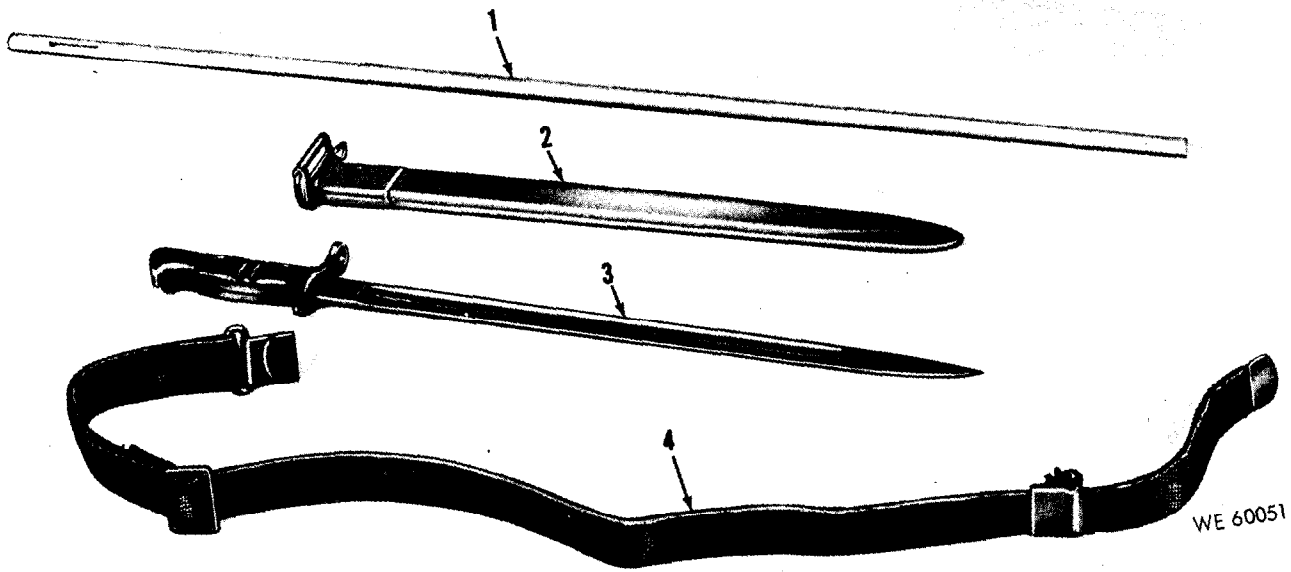

Reprinted by special permission of the copyright owner, Olin Mathieson Chemical Corp., Winchester - Western Division, New Haven, Conn.

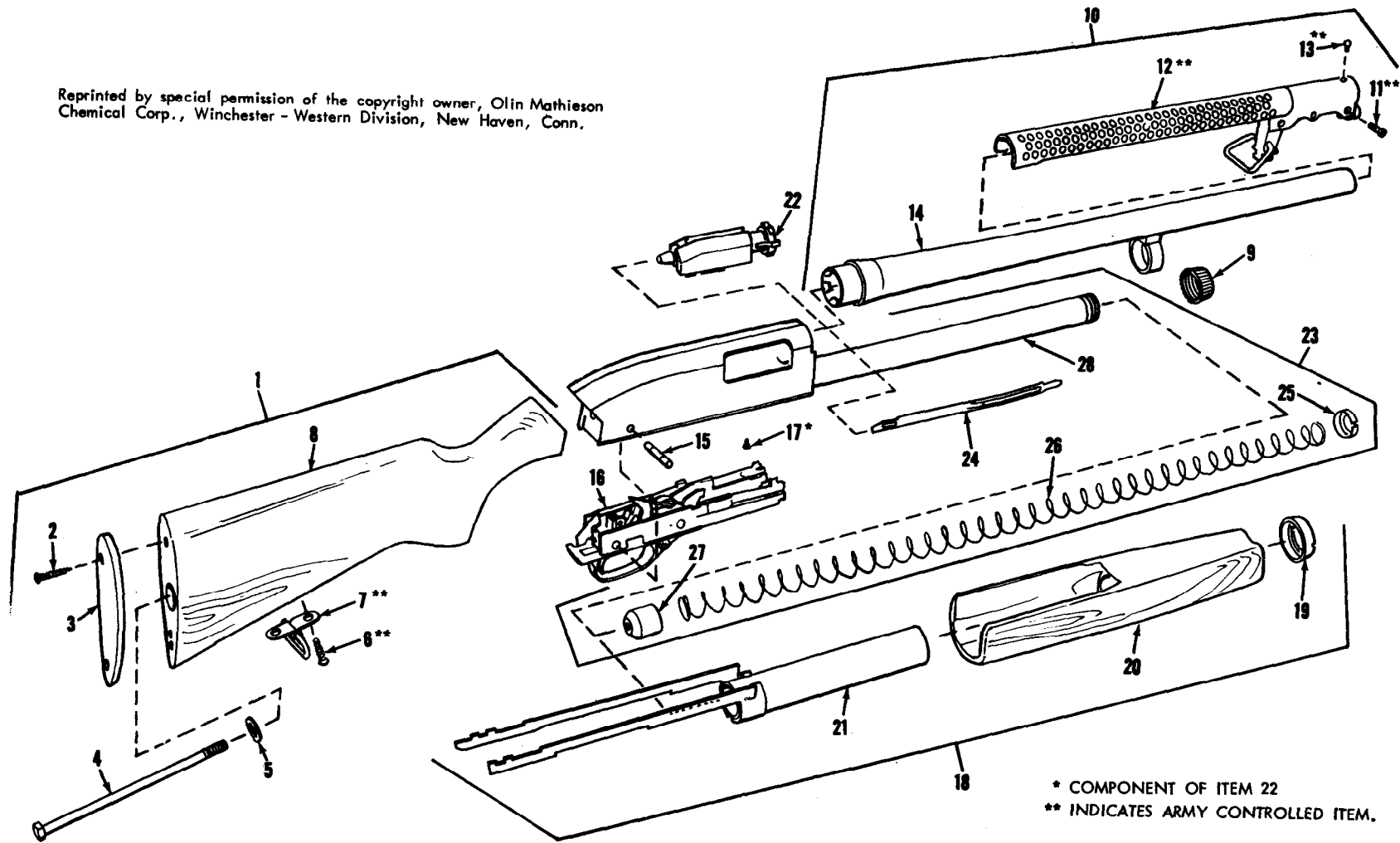

* COMPONENT OF ITEM 22
 ** INDICATES ARMY CONTROLLED ITEM.

WE 60054

Figure B-2. Major group assemblies and attaching parts.

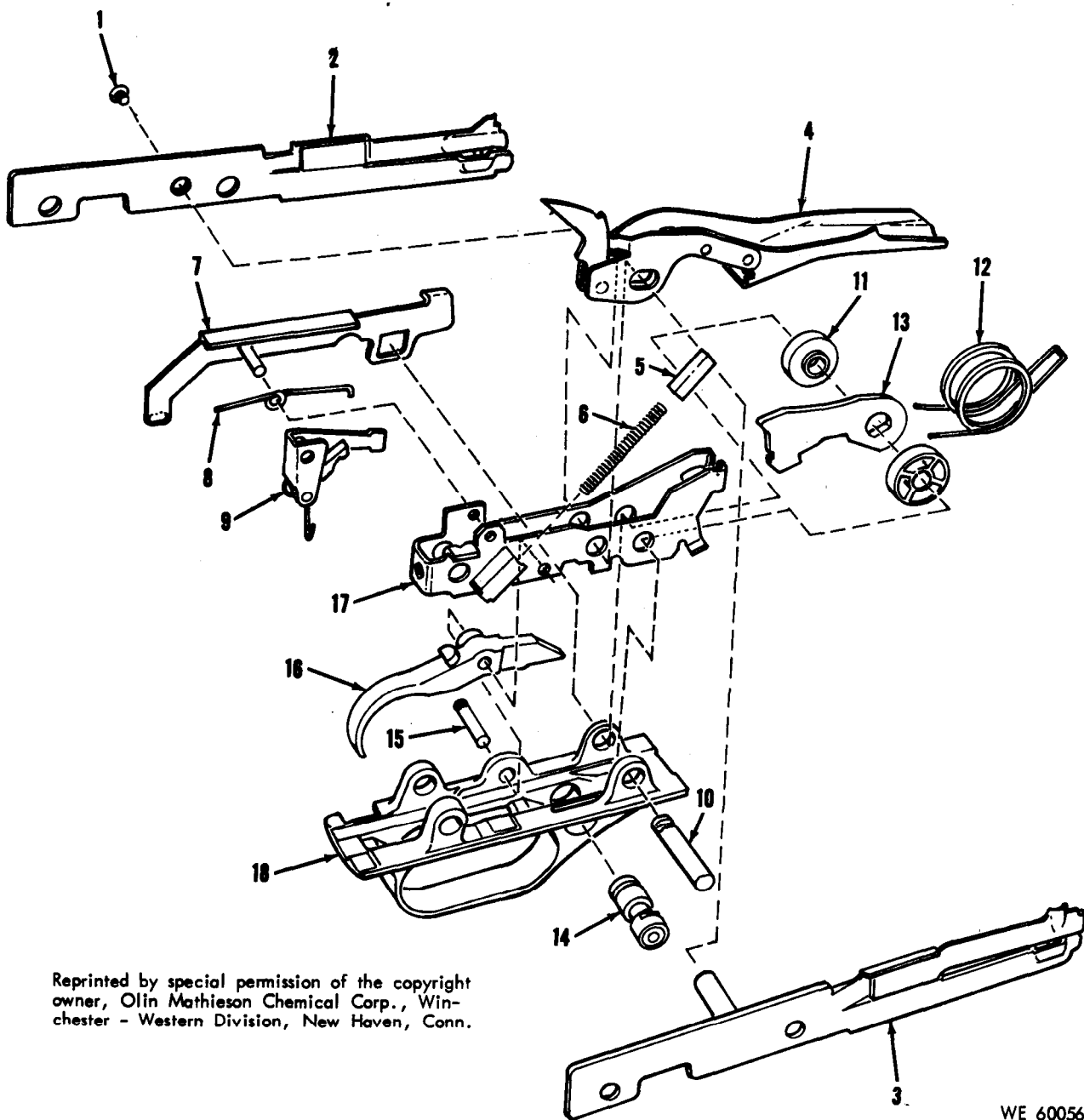

Reprinted by special permission of the copyright owner, Olin Mathieson Chemical Corp., Winchester - Western Division, New Haven, Conn.

WE 60056

Figure B-3. Trigger guard group.

Reprinted by special permission of the copyright owner, Olin Mathieson
Chemical Corp., Winchester - Western Division, New Haven, Conn.

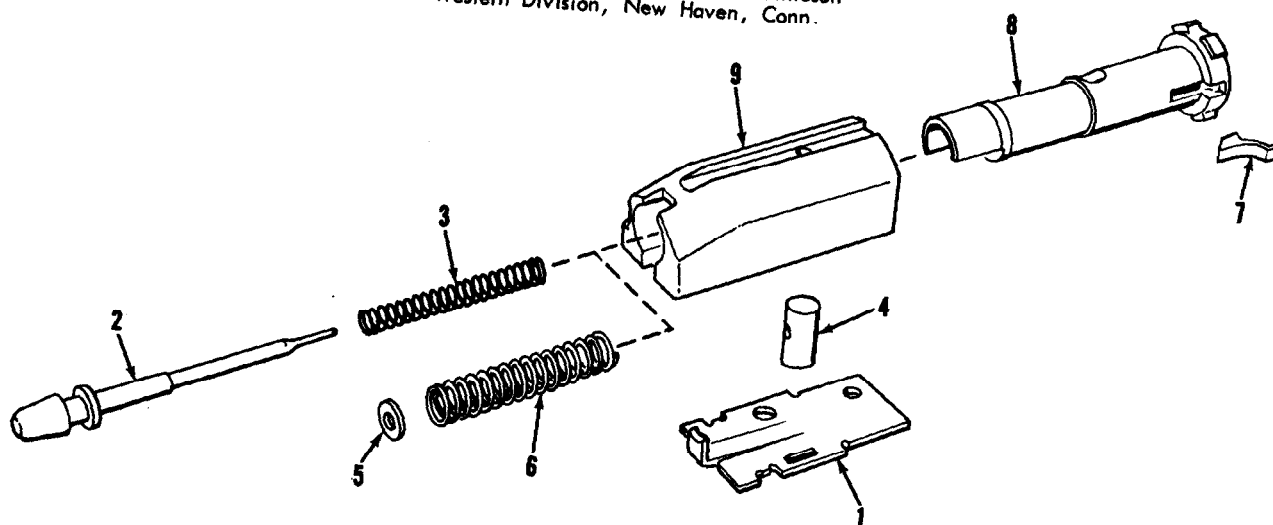

WE 6005

Figure B-4. Breech bolt group.

Section VIII INDEX—FEDERAL STOCK NUMBER AND REFERENCE NUMBER

CROSS-REFERENCE TO FIGURE AND ITEM NUMBER

<i>Stock Number</i>	<i>Figure No.</i>	<i>Item No.</i>	<i>Reference No.</i>	<i>Mfg Code</i>	<i>Fig. No.</i>	<i>Item No.</i>
1005-614-6873	B-2	6	8812-G-1390	66118	B-2	3
1005-614-7721	B-2	7	6146873	19205	B-2	6
1005-630-1446	B-1	1	6147721	19205	B-2	7
1005-654-4058	B-1	4	6284554	19205	B-2	11
1005-805-3267	B-2	13	6301446	19204	B-1	1
1005-805-3366	B-4	9	6544058	19204	B-1	4
1005-805-3367	B-2	8	7265706	19205	B-1	2
1005-805-3382	B-4	4	11686387	19204	B-2	13
1005-805-3409	B-2	26	11686389	19205	B-2	12
1005-805-3425	B-3	4	11686400	19204	B-1	3
1005-805-3440	B-3	5	12002514	66118	B-2	17
1005-805-3475	B-3	6	12008102	66118	B-4	8
1005-805-3488	B-3	7	12009112	66118	B-2	2
1005-805-3489	B-3	8	120014102	66118	B-2	4
1005-805-3537	B-2	24	120015102	66118	B-2	5
1005-805-3555	B-4	7	120016102	66118	B-4	4
1005-805-3602	B-4	6	120016212	66118	B-2	26
1005-805-3632	B-4	2	120017102	66118	B-3	4
1005-805-3686	B-4	5	120018102	66118	B-3	5
1005-805-3702	B-4	3	120019102	66118	B-3	6
1005-805-3709	B-2	20	120020102	66118	B-3	7
1005-805-3710	B-3	13	120021102	66118	B-3	8
1005-805-3711	B-3	17	120022102	66118	B-2	24
1005-805-3744	B-3	10	120024102	66118	B-4	7
1005-805-3745	B-3	12	120025102	66118	B-4	6
1005-805-3754	B-2	9	120026102	66118	B-4	2
1005-805-3939	B-2	27	120027102	66118	B-4	5
1005-805-4048	B-2	14	120028102	66118	B-4	3
1005-805-4066	B-3	11	120030102	66118	B-3	13
1005-805-4195	B-2	25	120032102	66118	B-3	10
1005-805-4201	B-3	14	120033102	66118	B-3	12
1005-805-4218	B-3	9	120034102	66118	B-2	9
1005-805-4244	B-4	1	120037102	66118	B-2	27
1005-805-4246	B-2	19	120041028	66118	B-2	14
1005-805-4257	B-2	21	120041270	66118	B-3	11
1005-805-4259	B-3	2	120044102	66118	B-2	25
1005-805-4284	B-3	3	120050102	66118	B-3	9
1005-805-4290	B-3	16	120053102	66118	B-4	1
1005-805-4291	B-3	18	120054102	66118	B-2	19
1005-805-4306	B-4	8	120057102	66118	B-3	2
1005-809-0721	B-2	3	120059102	66118	B-3	3
1005-913-2602	B-1	3	120061102	66118	B-3	16
1005-939-7170	B-2	12	120062102	66118	B-3	1
1095-726-5706	B-1	2	120066102	66118	B-2	15
5305-021-0114	B-2	17	120067102	66118	B-3	15
5305-021-0143	B-2	2	120012102-A	66118	B-4	9
5305-021-0411	B-3	1	120029102-AC	66118	B-2	20
5305-930-5729	B-2	11	120013102-D	66118	B-2	8
5306-020-9913	B-2	4	120031102-NS	66118	B-3	17
5310-017-8687	B-2	5	120049102-NS	66118	B-3	14
5315-017-8672	B-3	15	120055102-NS	66118	B-2	21
5315-017-8673	B-2	15	120063102-NS	66118	B-3	18

APPENDIX C

MAINTENANCE ALLOCATION CHART

Section I. INTRODUCTION

C-1. General

The maintenance allocation chart indicates specific maintenance operations performed at the proper maintenance levels. Deviation from maintenance operations allocated in the chart is authorized only upon approval of the commanding officer.

C-2. Maintenance Functions

This maintenance allocation chart designates overall responsibility for the maintenance function of an end item or assembly. Maintenance functions will be limited to and defined as follows:

INSPECT	To determine serviceability of an item by comparing its physical and mechanical, and electrical characteristics with established standards.
TEST	To verify serviceability and to detect electrical or mechanical failure by use of test equipment.
SERVICE	To clean, preserve, to charge, and to add fuel, lubricant, cooling agents and air.
ADJUST	To rectify to the extent necessary to bring into proper operating range.
ALIGN	To adjust specified variable elements of an item to bring to optimum performance.
CALIBRATE	To determine the corrections to be made in the reading of instruments or test equipment used in precise measurement. Consists of the comparison of two instruments, one of which is a certified standard of known accuracy, to detect and adjust any discrepancy in the accuracy of the instrument being compared with the certified standard.
INSTALL	To set up for use in an operational environment such as an emplacement, site, or vehicle.

REPLACE	To replace unserviceable items with serviceable assemblies, subassemblies, or parts.
REPAIR	To restore an item to serviceable condition. This includes but is not limited to inspection, cleaning, preserving, adjusting, replacing, welding, riveting, and strengthening.
OVERHAUL	To restore an item to a completely serviceable condition, as prescribed by maintenance serviceability standards, using the Inspect and Repair Only as Necessary (IROAN) Technique.
REBUILD	To restore an item to a standard as nearly as possible to original or new condition in appearance, performance and life expectancy. This is accomplished through complete disassembly of the item, inspection of all parts or components, repair or replacement of worn or unserviceable elements (items) using original manufacturing tolerances and specifications; and subsequent reassembly of the item.

C-3. Explanation of Format

Purpose and use of the format are as follows:

a. *Column a, Group Number.* Lists group numbers, to identify components and assemblies.

b. *Column b, Component Assembly Nomenclature.* Lists the noun names of groups and assemblies on which maintenance is authorized.

c. *Column c, Maintenance Functions.* Lists the various categories of maintenance to be performed on the weapon.

d. *Use of Codes.* Explanation of the use of codes in maintenance function, column c, is as follows:

Code	Explanation
C	Operator/Crew
O	Organizational Maintenance
F	Direct Support Maintenance
H	General Support Maintenance
D	Depot Maintenance

e. Column d, Tools and Equipment. This

column will be used to specify those tools and test equipment required to perform the designated function.

f. Column e, Remarks. Self-explanatory.

Note. Columns not utilized are considered not applicable.

Section II. MAINTENANCE ASSIGNMENT

a Group Number	Component assembly nomenclature b	Maintenance function c										Tools and equipment d	Remarks e	
		Inspect	Test	Service	Adjust	Align	Calibrate	Install	Replace	Repair	Overhaul			Rebuild
1	GUN SHOULDER STOCK GROUP	C		C				F		F				
2	BARREL AND BAYONET BAND ASSEMBLY	C		C				O		O				
2a	BARREL ASSEMBLY	C		C				O	F	O				
2b	BAYONET BAND ASSEMBLY	C		C				O	O	O				
3	TRIGGER GUARD GROUP	C		C				F		F				
4	FORE END GROUP	C		C				F		F				
5	BREECH BOLT GROUP	C		C				F		F				
6	RECEIVER AND MAGAZINE GROUP	C		C				O		F				

By Order of the Secretary of the Army:

WILLIAM C. WESTMORELAND,
General, United States Army,
Chief of Staff.

Official:

KENNETH G. WICKHAM,
Major General, United States Army,
The Adjutant General.

Distribution:

To be distributed in accordance with DA Form 12-40 requirements (qty rqr Block #147) for October and Crew, Shotgun, 12-guage, Winchester, Model 1200, riot type, 20-inch barrel.

☆ U.S. GOVERNMENT PRINTING OFFICE: 1985-461-421/21336